Comfort-Aire®

 **Century**®

MARS®
Delivering Confidence

REPLACEMENT PARTS LIST

Single Zone Ductless Mini-Split with Inverter Technology

A-SSP12SA-0

EXPLODED VIEW

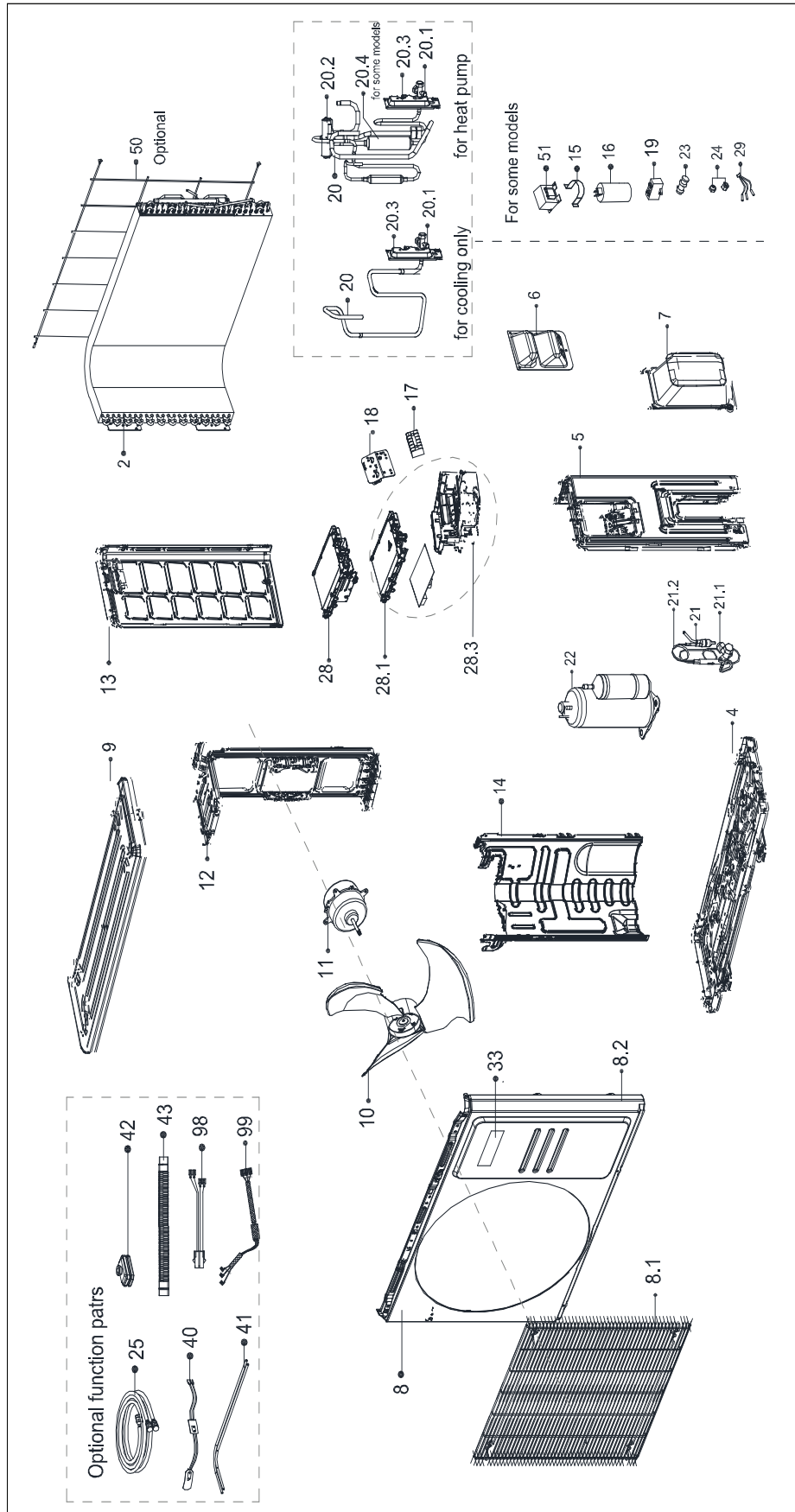

REPLACEMENT PARTS

Location	Part Name	Quantity	Part No.
2	Condenser assembly	1.0	15822000009658
4	Chassis assembly	1.0	12222000013427
5	Right side plate	1.0	12222000012141
6	Handle	1.0	12222000010966
7	Water collector	1.0	12122000007150
8	Front panel assembly	1.0	12222000A06310
8.1	Air outlet grille	1.0	12222000015025
8.2	Front panel	1.0	12222000A06311
9	Top cover	1.0	12222000014305
10	Axial flow fan	1.0	12100105000821
11	Motor	1.0	11002015020053
12	Motor bracket	1.0	12222000012390
13	Left supporter	1.0	12222000012135
14	Partition board	1.0	12222000013428
17	Terminal block	1.0	17400401006456
18	Supporter board	1.0	12222000019881
20	4-ways valve or Gas valve assembly	1.0	15422000025728
20.1	Gas valve	1.0	15500204000665
20.2	4-way valve	1.0	15500216002563
20.3	Valve plate	1.0	1222200005738
20.4	Muffler assembly	1.0	15122000030139
21	High pressure valve assembly	1.0	15422000024078
21.1	High pressure valve	1.0	15500208000028
21.2	Capillary	1.0	15122000011919
22	Compressor	1.0	11103020005082
24	Copper nut	1.0	15500406000016
24	Copper nut	1.0	15500406000010
28	Electronic control box assembly	1.0	17222000043604
28.1	Electrical installation plate	1.0	12122000030601
28.3	Electronic installing box assembly	1.0	12122000030602
29	Combination sensor	1.0	11201007007503
33	Outdoor unit trademark	1.0	16000201001228
40	Crankcase electric heater	1.0	17402001000559
41	Electric heater of chassis	1.0	17402002000465
50	Rear Grille	1.0	12222000012385
51	Reactor	1.0	17400306001263
99	Compressor connection cable	1.0	17401203012697

Due to ongoing product improvements, specifications and dimensions are subject to change and correction without notice or incurring obligations. Determining the application and suitability for use of any product is the responsibility of the installer. Additionally, the installer is responsible for verifying dimensional data on the actual product prior to beginning any installation preparations.

Incentive and rebate programs have precise requirements as to product performance and certification. All products meet applicable regulations in effect on date of manufacture; however, certifications are not necessarily granted for the life of a product. Therefore, it is the responsibility of the applicant to determine whether a specific model qualifies for these incentive/rebate programs.



1900 Wellworth Ave., Jackson, MI 49203 • Ph. 517-787-2100 • www.marsdelivers.com



Comfort-Aire®

 **Century**®

MARS®
Delivering Confidence

REPLACEMENT PARTS LIST

Single Zone Ductless Mini-Split with Inverter Technology

B-SSP12SA-0

REPLACEMENT PARTS

Location	Part Name	Quantity	Part No.
1	Panel assembly	1.0	12122000A57212
2	Air filter	2.0	12122000015224
3	Display box assembly	1.0	17222000043475
3.1	Display board assembly	1.0	17122000063108
4	Cover for electrical parts	1.0	12122000013131
5	Panel frame assembly	1.0	12122000013170
5.1	Screw cover	2.0	12122000013139
6	Right cover of chassis	1.0	12122000013140
7	Cover of wiring terminal subassembly	1.0	12122000013141
8	Horizontal louver	1.0	12122000013168
9	evaporator assembly	1.0	15822000015391
10	Cover, fan motor	1.0	12122000013129
11	Motor	1.0	11002012005527
12	bearing holder	1.0	12122000000350
13	bearing base	1.0	12622000000131
14	Cross flow fan	1.0	12100102000044
15	Gas sensor	1.0	11201003000364
16	Chassis assembly	1.0	12122000035142
16.1	Stepper motor	1.0	11002010000143
16.2	Drain pipe joint	1.0	12100501000032
16.3	louver assembly	1.0	12122000013167
16.4	Left cover of chassis	1.0	12122000013123
16.5	Insulated axis	1.0	12122000000344
16.6	Drainage plug	1.0	12622000000030
17	Pipe clamp board	1.0	12122000013136
18	Installation plate	1.0	12222000A03012
19	Structural components of indoor electric control box	1.0	17222000043603
19.4	Indoor main control board subassembly	1.0	17122000063301
19.6	Pipe temperature sensor subassembly	1.0	11201007003447
19.7	Terminal block	1.0	17400401000006
19.9	Ambient temperature sensor subassembly	1.0	11201007003424
20	Cover of electronic control box	1.0	12122000013132
21	remote controller	1.0	17317000012079
40	Air freshening filter	1.0	12100204000685
42	Detection valve	1.0	15500209000001
46	Copper nut	1.0	15500406000016
46	Copper nut	1.0	15500406000010

Due to ongoing product improvements, specifications and dimensions are subject to change and correction without notice or incurring obligations. Determining the application and suitability for use of any product is the responsibility of the installer. Additionally, the installer is responsible for verifying dimensional data on the actual product prior to beginning any installation preparations.

Incentive and rebate programs have precise requirements as to product performance and certification. All products meet applicable regulations in effect on date of manufacture; however, certifications are not necessarily granted for the life of a product. Therefore, it is the responsibility of the applicant to determine whether a specific model qualifies for these incentive/rebate programs.

Comfort-Cire®  **Century**®

1900 Wellworth Ave., Jackson, MI 49203 • Ph. 517-787-2100 • www.marsdelivers.com

